

Model: ASSL-100

16ft Stick Ladder

- Always Wear A Safety Harness With This Product
- Practice Using At Ground Level
- Weight Limit **300 lbs.**

Parts List

A	1 Top Section	Part # WL-1000
B	2 Middle Section	Part # WL-1250
C	1 Bottom Section	Part # WL-1500
D	4 Tree Brace	Part # WTB-100
E	4 Buckle Strap Assy	Part # WBA-100
	3 M6 Quickclips	Part # 1615
60	4 M8x60mm Bolt	Part # 1860W w/wingnut

Thank you for purchasing the Sportsman's Stick Ladder by Tahsin Industrial Corp USA. The Stick Ladder requires some assembly. You will find detailed instructions with your Stick Ladder. The following instructions will tell you how to assemble and use your Stick Ladder. Every year hunters are seriously injured in treestand accidents. Please carefully read and follow these instructions. For missing or damaged parts visit www.treestandcustomerservice.com or call 1-800-722-7345.

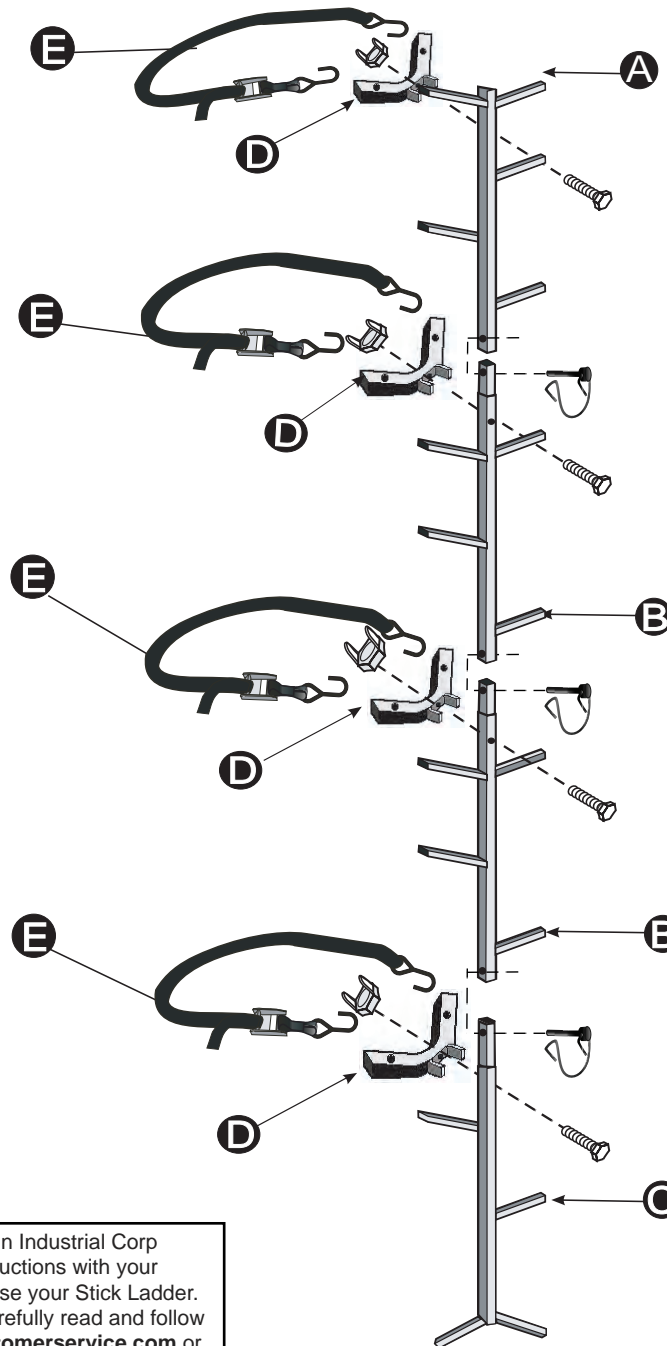

Warning Warning

1. **ALWAYS** read all warnings and instructions before each use of stick ladder. Failure to read all warnings and instructions before each use of stick ladder may result in serious injury or death.
2. Remove all contents from box. Remove all cardboard from the product. Inspect for any damaged or missing pieces. **DO NOT** assemble or use stick ladder if any parts are missing or damaged. Using the stick ladder with missing or damaged parts may result in serious injury or death. Missing or damaged parts may be obtained from the address and phone number listed below.
3. **DO NOT** use stick ladder if any bolts or nuts are loose, bent or crooked.
4. Be sure to retighten all bolts before each new use of stick ladder.
5. Weight limit of this stick ladder is **300 lbs.** **DO NOT** use stick ladder if you or your combined weight with any accessories are more than **300 lbs.** Using this stick ladder when over **300 lbs.** may result in serious injury or death.
6. **ALWAYS** use a full body safety harness with climbing belt when using this stick ladder. Failure to use a full body safety harness with climbing belt may result in serious injury or death.
7. **NEVER** use stick ladder if you have dizzy spells, a heart condition, are afraid of heights, have been advised by a doctor or other healthcare provider not to climb, or have any condition that would impair your ability to climb up or down or use stick ladder as it could result in serious injury or death. Please consult a physician prior to use.
8. **DO NOT** use stick ladder under the influence of alcohol, medication, or any illegal substances. Using the stick ladder while under influence of any of these substances may result in serious injury or death.
9. **NEVER** use stick ladder during inclement weather. **DO NOT** use stick ladder during thunderstorms or any other weather conditions that included (but not limited to) lightning, freezing rain that could create slippery or dangerous conditions.
10. **DO NOT** use the stick ladder unless the ground is dry or level. Failure to use stick ladder when the ground is dry or level may result in serious injury or death.
11. **NEVER** use stick ladder on a tree that is dead, diseased, leaning, or on wet and uneven ground as the tree may fall, break, or uproot and may result in serious injury or death.
12. **DO NOT** leave your stick ladder outside all year round. It must be stored inside when not in use.
13. **NEVER** climb stick ladder with your weapon. Make sure that the unloaded firearm gun barrel is pointed toward the ground when raising or lowering it to your stand. Always use a safe hoist/lift system on the opposite side of the tree from which you are climbing.
14. **ALWAYS** unload you weapon and use safety lock while raising or lowering your weapon. Failure to unload your weapon may result in serious injury or death.
15. Use stick ladder on trees with a minimum diameter of 9" and maximum of 20".
16. **ALWAYS** have a communication device on your person and easily accessible. Immediate access to another person may save your life. In the event of an accident, a rescue plan must be in place and able to be incorporated immediately.

ASSL-100 16 Ft Stick Ladder Assembly Instructions

1. The first step of Bottom Section **C** should be placed on the right hand side. (Fig. 1).
2. Attach Tree Brace **D** to each stick ladder section using 4 - **M8x60mm** bolts and wing nuts provided. Wing nut must be installed facing the tree. (Fig. 2). Tighten securely.
3. The first step of the Second Section **B** should be facing the right hand side. Assemble all stick sections together (Fig. 3). Make sure all connections are tightened securely. Insert one quickclip into each section at the insertion point. (Fig. 4)

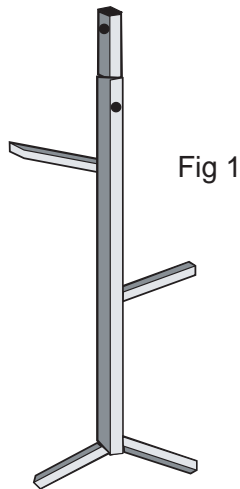

Fig 1

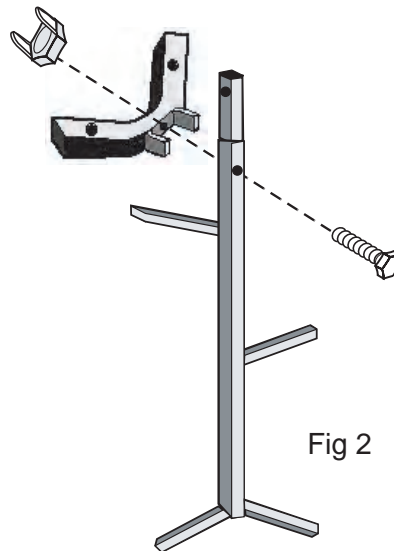

Fig 2

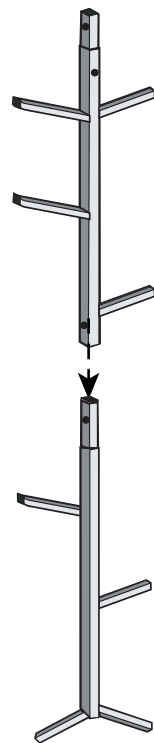

Fig 3

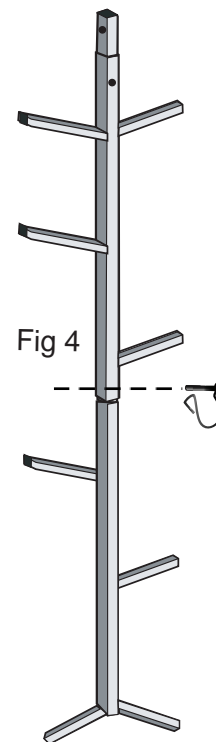

Fig 4

Warning ⚠ Warning ⚠ Warning

1. **ALWAYS** read all warnings and instructions before each use of stick ladder. Failure to read all warnings and instructions before each use of stick ladder may result in serious injury or death.
2. Remove all contents from box. Remove all cardboard from the product. Inspect for any damaged or missing pieces. **DO NOT** assemble or use stick ladder if any parts are missing or damaged. Using the stick ladder with missing or damaged parts may result in serious injury or death. Missing or damaged parts may be obtained from the address and phone number listed below.
3. **DO NOT** use stick ladder if any bolts or nuts are loose, bent or crooked.
4. Be sure to retighten all bolts before each new use of stick ladder.
5. Weight limit of this stick ladder is **300 lbs**. **DO NOT** use stick ladder if you or your combined weight with any accessories are more than **300 lbs**. Using this stick ladder when over **300 lbs**. may result in serious injury or death.
6. **ALWAYS** use a full body safety harness with climbing belt when using this stick ladder. Failure to use a full body safety harness with climbing belt may result in serious injury or death.
7. **NEVER** use stick ladder if you have dizzy spells, a heart condition, are afraid of heights, have been advised by a doctor or other healthcare provider not to climb, or have any condition that would impair your ability to climb up or down or use stick ladder as it could result in serious injury or death. Please consult a physician prior to use.
8. **DO NOT** use stick ladder under the influence of alcohol, medication, or any illegal substances. Using the stick ladder while under influence of any of these substances may result in serious injury or death.
9. **NEVER** use stick ladder during inclement weather. **DO NOT** use stick ladder during thunderstorms or any other weather conditions that included (but not limited to) lightning, freezing rain that could create slippery or dangerous conditions.
10. **DO NOT** use the stick ladder unless the ground is dry or level. Failure to use stick ladder when the ground is dry or level may result in serious injury or death.
11. **NEVER** use stick ladder on a tree that is dead, diseased, leaning, or on wet and uneven ground as the tree may fall, break, or uproot and may result in serious injury or death.
12. **DO NOT** leave your stick ladder outside all year round. It must be stored inside when not in use.
13. **NEVER** climb stick ladder with your weapon. Make sure that the unloaded firearm gun barrel is pointed toward the ground when raising or lowering it to your stand. Always use a safe hoist/lift system on the opposite side of the tree from which you are climbing.
14. **ALWAYS** unload you weapon and use safety lock while raising or lowering your weapon. Failure to unload your weapon may result in serious injury or death.
15. Use stick ladder on trees with a minimum diameter of 9" and maximum of 20".
16. **ALWAYS** have a communication device on your person and easily accessible. Immediate access to another person may save your life. In the event of an accident, a rescue plan must be in place and able to be incorporated immediately.

ASSL-100 16 Ft Stick Ladder Assembly Instructions

1. Stand the assembled stick ladder upright next to the tree so that all of the Tree Braces are firmly against the tree. **(Fig. 5)** The stick ladder must be straight and vertical. **DO NOT** use on a leaning or dead tree. Tree should have a diameter between 9 and 20 inches.
2. Press your weight on the first step so that the base of the bottom section settles firmly and completely into the ground.
3. Attach each hook of the Buckle Strap Assembly to the Tree Brace **D** **(Fig.6)** and wrap the strap around the back of the tree. Make sure that the strap is flat against tree with no slack. **(Fig. 3)**. Then securely fasten to tree brace **(See Detailed S-hook Buckle and Strap Instructions)**. Secure section to the tree before climbing.
4. Attach Safety Harness to yourself and the tree according to the manufacturer's instructions.
5. Climb the bottom section of the stick ladder to reach the Second Section. Attach the second strap. Make sure section is secure before climbing any further.
6. Repeat for third and fourth sections.
7. When installing and removing stick ladder sections do not undo any strap until you are standing securely on the section below.

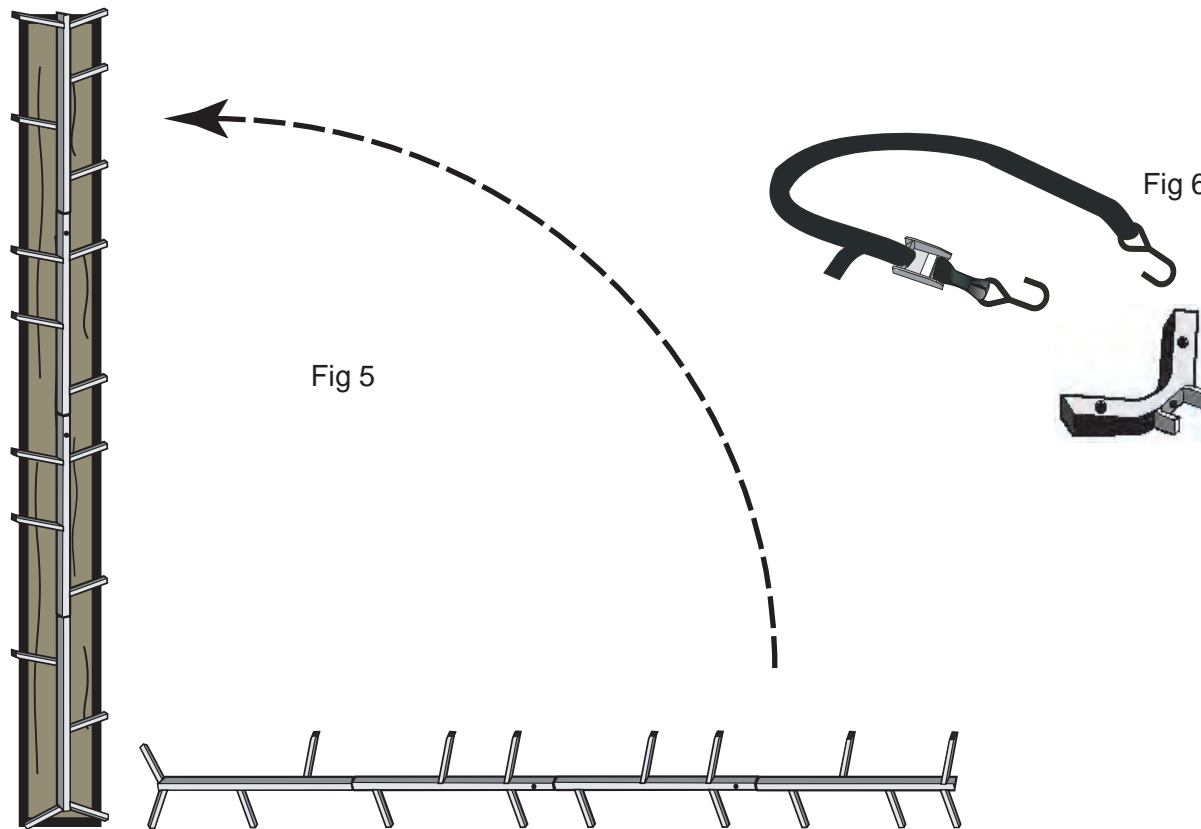

Warning ⚠ Warning ⚠ Warning

1. **ALWAYS** read all warnings and instructions before each use of stick ladder. Failure to read all warnings and instructions before each use of stick ladder may result in serious injury or death.
2. Remove all contents from box. Remove all cardboard from the product. Inspect for any damaged or missing pieces. **DO NOT** assemble or use stick ladder if any parts are missing or damaged. Using the stick ladder with missing or damaged parts may result in serious injury or death. Missing or damaged parts may be obtained from the address and phone number listed below.
3. **DO NOT** use stick ladder if any bolts or nuts are loose, bent or crooked.
4. Be sure to retighten all bolts before each new use of stick ladder.
5. Weight limit of this stick ladder is **300 lbs**. **DO NOT** use stick ladder if you or your combined weight with any accessories are more than **300 lbs**. Using this stick ladder when over **300 lbs**. may result in serious injury or death.
6. **ALWAYS** use a full body safety harness with climbing belt when using this stick ladder. Failure to use a full body safety harness with climbing belt may result in serious injury or death.
7. **NEVER** use stick ladder if you have dizzy spells, a heart condition, are afraid of heights, have been advised by a doctor or other healthcare provider not to climb, or have any condition that would impair your ability to climb up or down or use stick ladder as it could result in serious injury or death. Please consult a physician prior to use.
8. **DO NOT** use stick ladder under the influence of alcohol, medication, or any illegal substances. Using the stick ladder while under influence of any of these substances may result in serious injury or death.
9. **NEVER** use stick ladder during inclement weather. **DO NOT** use stick ladder during thunderstorms or any other weather conditions that included (but not limited to) lightning, freezing rain that could create slippery or dangerous conditions.
10. **DO NOT** use the stick ladder unless the ground is dry or level. Failure to use stick ladder when the ground is dry or level may result in serious injury or death.
11. **NEVER** use stick ladder on a tree that is dead, diseased, leaning, or on wet and uneven ground as the tree may fall, break, or uproot and may result in serious injury or death.
12. **DO NOT** leave your stick ladder outside all year round. It must be stored inside when not in use.
13. **NEVER** climb stick ladder with your weapon. Make sure that the unloaded firearm gun barrel is pointed toward the ground when raising or lowering it to your stand. Always use a safe hoist/lift system on the opposite side of the tree from which you are climbing.
14. **ALWAYS** unload you weapon and use safety lock while raising or lowering your weapon. Failure to unload your weapon may result in serious injury or death.
15. Use stick ladder on trees with a minimum diameter of 9" and maximum of 20".
16. **ALWAYS** have a communication device on your person and easily accessible. Immediate access to another person may save your life. In the event of an accident, a rescue plan must be in place and able to be incorporated immediately.

DETAILED S-HOOK BUCKLE AND STRAP INSTRUCTIONS



Fig. 1

1. Hold buckle as shown in (Fig. 1)

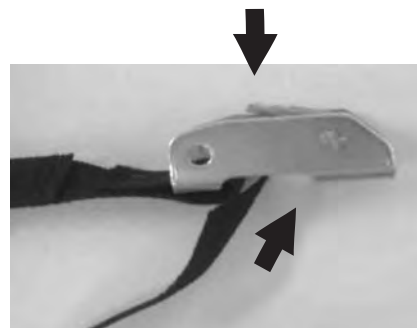

Fig. 2

2. Press down on latch and insert strap underneath teeth and flat piece of metal as shown in (Fig. 2).



Fig. 3

3. Pull strap to desired length. (Fig. 3)

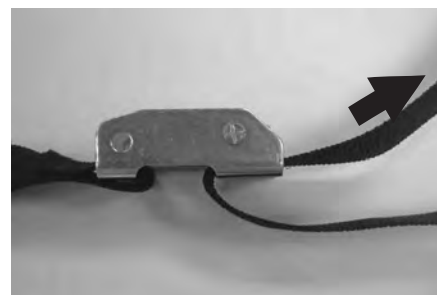

Fig. 4

4. Wrap strap around tree and insert hooks into holes on tree brace. Pull slack until tightened. (Fig. 4)

Always tug on strap to make sure it is secured by the buckle